

INSTRUCTIONS FOR IDENTIFYING ASSESSOR'S PARCEL NUMBERS

Office of Ventura County Assessor's, Ventura, California

EXAMPLE: 086-0-083-015

086=Assessor's Map Book

-0=Expansion Digit

-08=Page Number of Book 086

3=Block Number of Page 08. If a zero (080) appears here it indicates that the page has no individual blocks.

-01= Parcel of Block 083

5=Suffix Number indicates

interest.....(See definitions below)

- 5= Pipeline Right of Way Assessment
- 7= "Fee & Leasehold" Sand & Gravel Production
- 8= "Fee" Mineral Rights (Producing owned in fee)
- 9= "Leasehold" Mineral Rights (leased from Fee Owner)

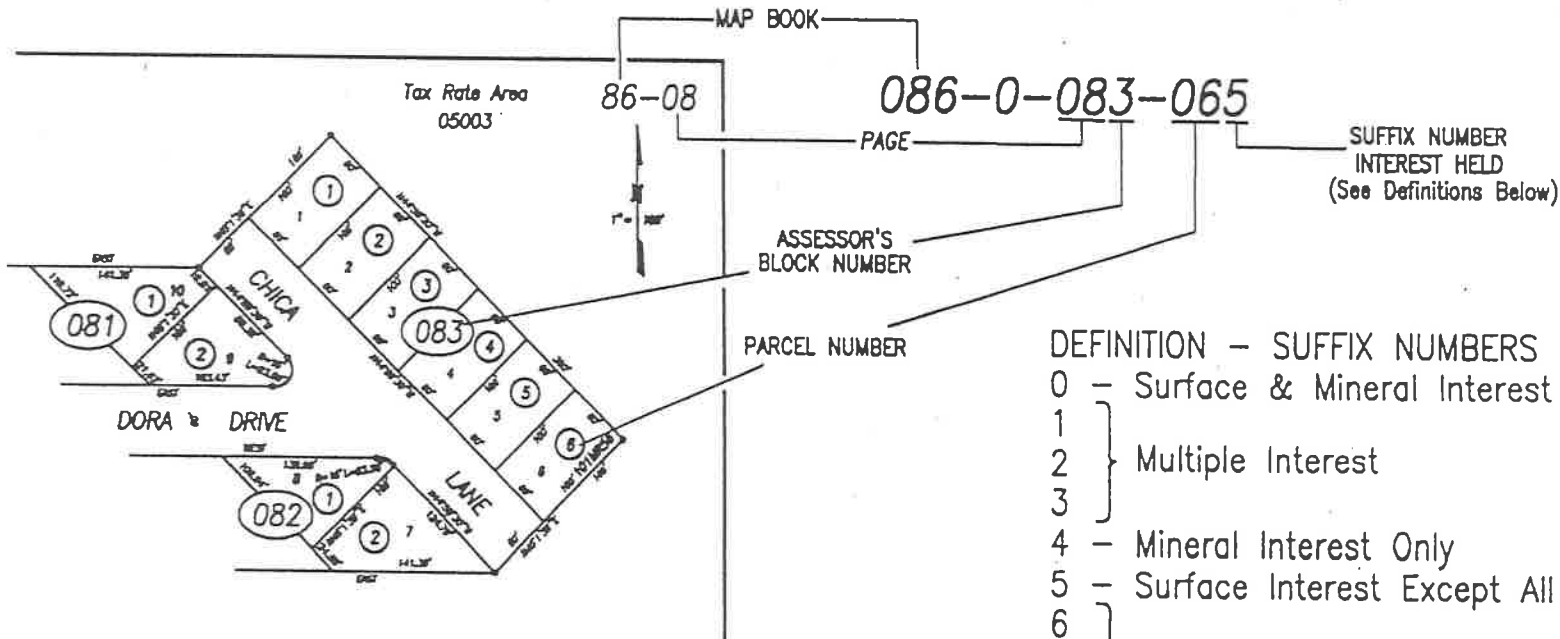

ASSESSOR'S MAP SYMBOLS



Parcel Number - A quarter of an inch circle with a number assigned to a specific parcel on the map.



1.00Ac.

Parcel Number With Acreage - A parcel that contains one acre or more.



Voided Parcel - A parcel that has been cancelled.

465

Lot Number - A number assigned to a specific plot of land recorded under the Subdivision Map Act.

455

Ghosted Lot Number - A lot number that has had its original lot boundaries altered.

Por. A



Alpha Parcel - Parcel designation under the Subdivision Map Act.



Adjacent Book Number - A 9/16th circle with an Assessor's book number noting an adjacent book.



Adjacent Page Number - A 3/8th circle with an Assessor's page number noting an exterior adjacent page.



Adjacent Page Number - A 3/8th circle with an Assessor's page number noting an interior adjacent page.

Block Number - A 5/8th ellipse noting the block division of a page.

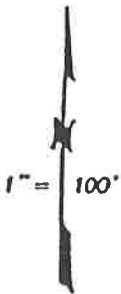

North Arrow - Orientation symbol for true North noting the map scale.

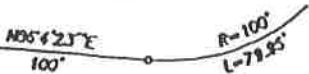

Tick Mark - A 1/32nd circle noting the end of a bearing or course on the map.

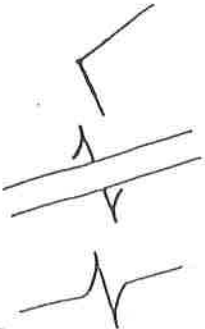

Map Dimension - Bearing or radius and length of a course based on an official record.

Tract Boundary - Subdivision boundary established per a book of Miscellaneous Records.

Land Hook - Notes a parcel with one assessment but divided by a road, flood control channel, etc.

Foreshorten - Designates courses shortened to fit on page.



Road Way - Right-a-way outlined in a heavy line.